

STATEMENT OF AREA

LAND AREA :- 15297.414 M²
 PERMISSIBLE GR. COV. AREA :- 7648.70 M²

Sl. NO	BLOCK	GR. COV. AREA	NUMBER OF SHEET
1	1	603.77 M ²	DRAWING ARE SAME AS BLOCK-1
2	7	603.77 M ²	
3	9	603.77 M ²	
4	11	603.77 M ²	DRAWING ARE SAME AS BLOCK-5
5	2	540.29 M ²	
6	3	538.22 M ²	DRAWING ARE SAME AS BLOCK-5
7	4	784.71 M ²	
8	5	603.77 M ²	DRAWING ARE SAME AS BLOCK-5
9	6	603.77 M ²	
10	8	884.96 M ²	DRAWING ARE SAME AS BLOCK-5
11	10	936.47 M ²	
12	12	347.11 M ²	COMMERCIAL BLDG. CENTRALLY AIR CONDITION
TOTAL		7644.38 M²	

LAND TO BE DONATED TO BALLY MUNICIPALITY FOR WIDENING BELUR ROAD. 12881 M² OR 1385.99 SFT. MIL

PORTION OF LAND DONATED TO BALLY MUNICIPALITY FOR WIDENING SETH PARASRAM BAZAZ ROAD. 26101 M² OR 2808.46 SFT. MIL

TOTAL :- 389,82 M² OR 41,44.46 SFT



SANCTIONED
 Vice Chairman
 BALLY MUNICIPALITY

Valid Upto: 22.11.12
 5111. 5P. 236 Dt. 3/08

BY ORDER
 Chairman/ Vice-Chairman



DETAILS OF 100 USERS SP TANK & S. WELL
 SCALE :- 1 : 50
 14 NOS OF SP TANK

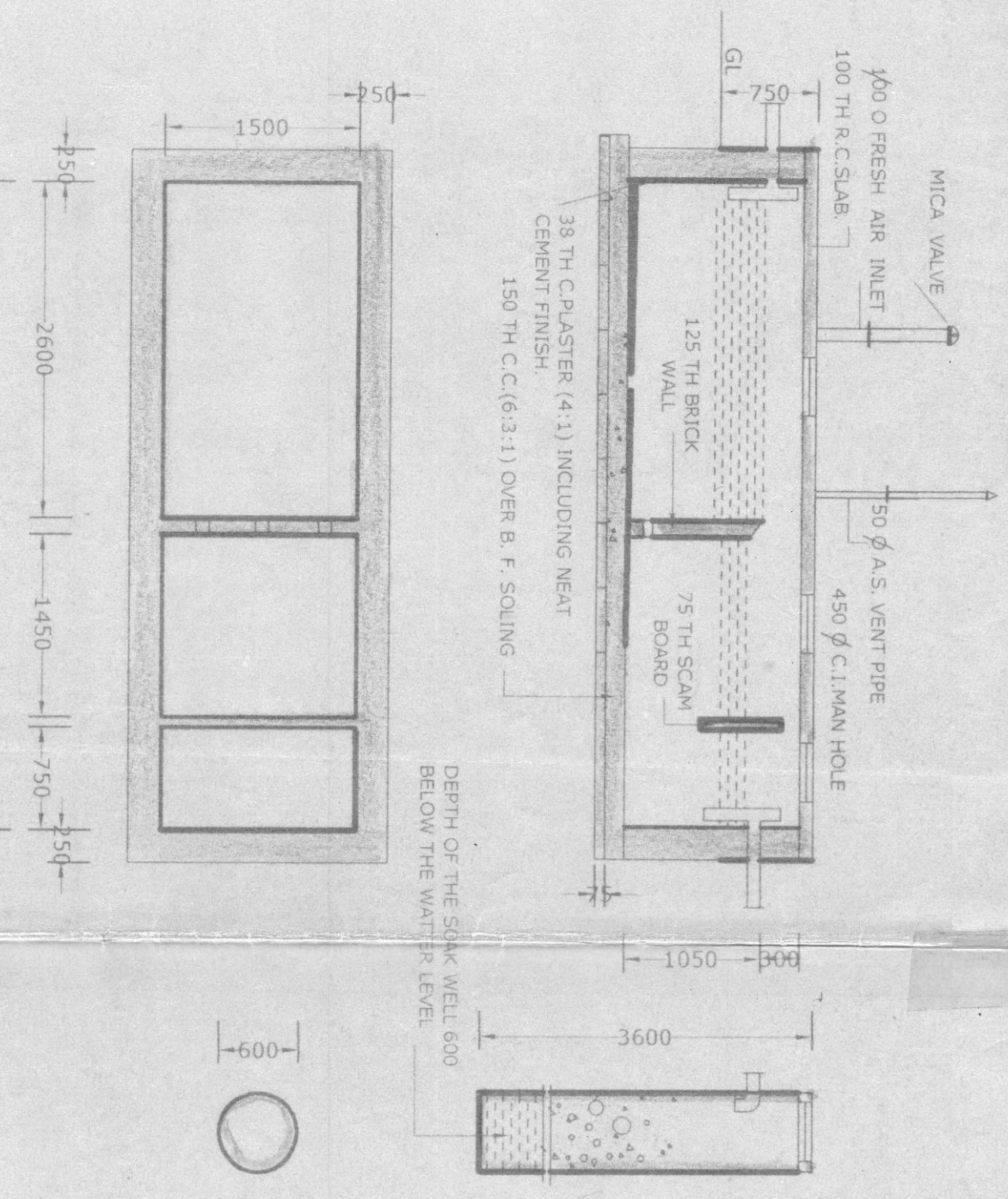

DETAILS OF 50 USERS SP TANK & S. WELL
 SCALE :- 1 : 50
 9 NOS OF SP TANK

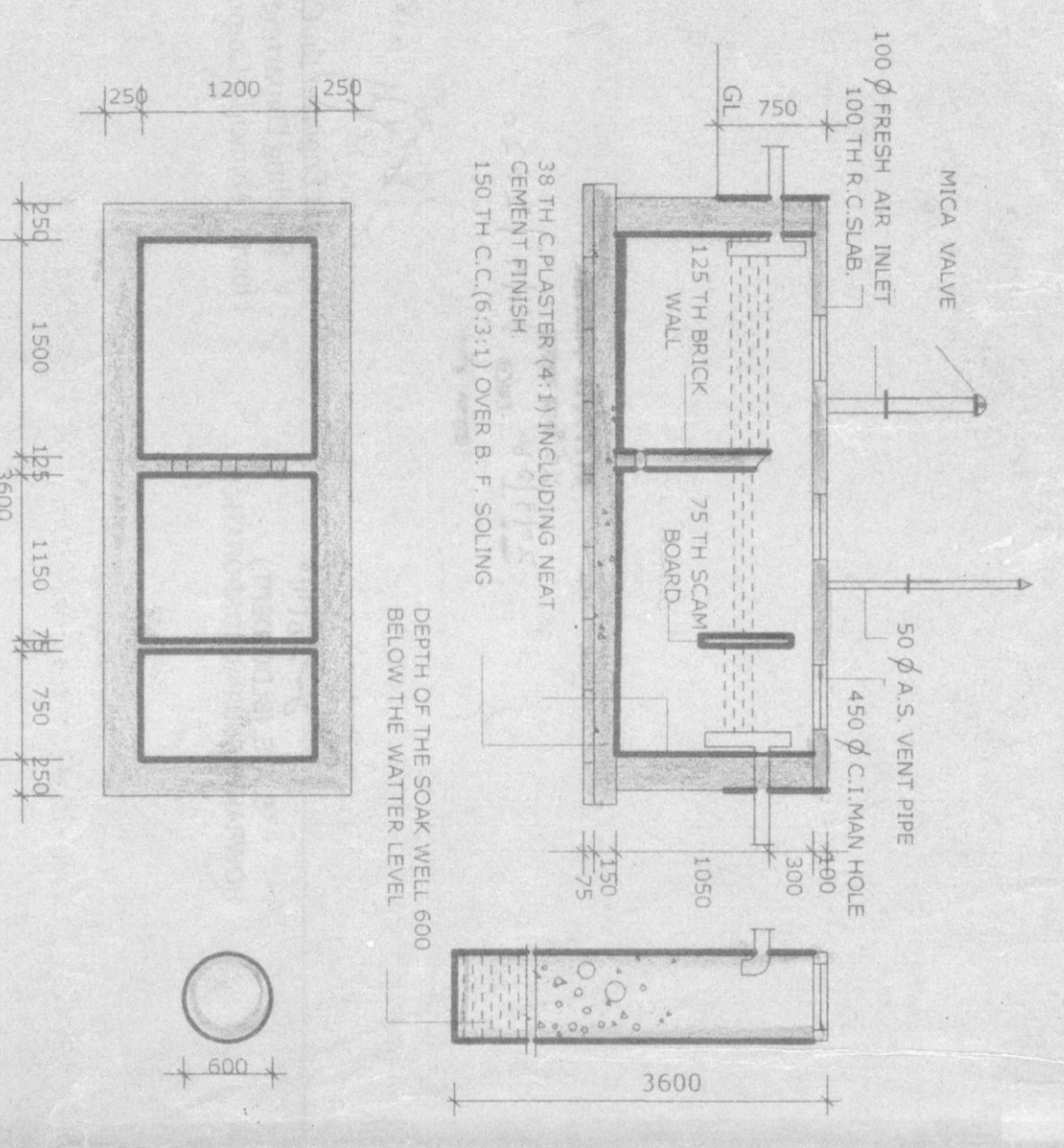

PROPOSED CONSTRUCTION AT
 HOLDING NO. 10 SETH PARASRAM
 BAZAZ ROAD, LILUAH.WD.-NO.20.
 UNDER BALLY MUNICIPALITY
 DIST - HOWRAH.
 SCALE :- 1:500(1:50)

OWNERS SIGNATURE

Om Prakash Bhowmik
 Om Prakash Bhowmik
 Consultant Authority of
 Arivala Builders Works & Research Pvt. Ltd.

Engineer (L.S. & Structural Engineer)
 BALLY MUNICIPALITY

Revised

2019/2020

Assistant Engineer (In-Charge)
Building Department
Howrah Municipal Corporation

S. A. E. (BLOG. DEPT.)
HOWRAH MUNICIPAL CORPORATION

S. M. S. S.
2019